

Timber Towers



Single Deck Unit 1

Product Dimensions
3411mm (L) 1018mm (W) 1845mm (H)

Minimum Surface Area: 23.52m²
6878mm (L) 4018mm (W)

Free Fall Height: 900mm



Single Deck Unit 3

Product Dimensions
3620mm (L) 2147mm (W) 3201mm (H)

Minimum Surface Area: 26.44m²
7073mm (L) 5140mm (W)

Free Fall Height: 1200mm



Single Deck Unit 2

Product Dimensions
4145mm (L) 1082mm (W) 3147mm (H)

Minimum Surface Area: 25.61m²
7614mm (L) 4018mm (W)

Free Fall Height: 1200mm



Single Deck Unit 4

Product Dimensions
5550mm (L) 2094mm (W) 2970mm (H)

Minimum Surface Area: 32.97m²
8984mm (L) 5102mm (W)

Free Fall Height: 1500mm



Double Deck Unit 1

Product Dimensions
5837mm (L) 2717mm (W) 2320mm (H)

Minimum Surface Area: 37.48m²
9289mm (L) 5706mm (W)

Free Fall Height: 1327mm



Double Deck Unit 2

Product Dimensions
5744mm (L) 4145mm (W) 2310mm (H)

Minimum Surface Area: 45.82m²
8734mm (L) 7614mm (W)

Free Fall Height: 1200mm

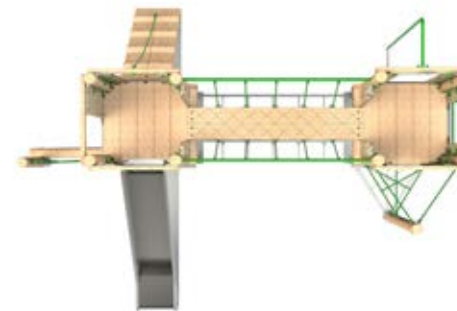
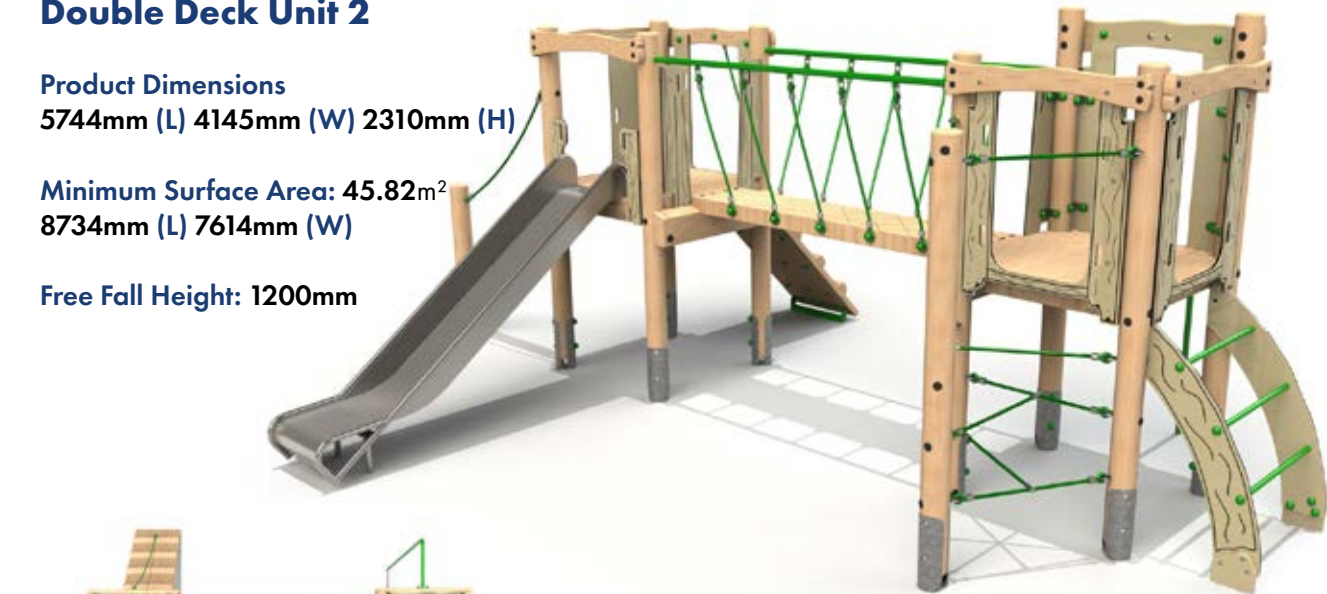

Double Deck Unit 3

Product Dimensions
6613mm (L) 1669mm (W) 3149mm (H)

Minimum Surface Area: 39.05m²
10082mm (L) 4607mm (W)

Free Fall Height: 1200mm



Timber Towers

Timber Towers

Double Deck Unit 4

Product Dimensions
7507mm (L) 1835mm (W) 3501mm (H)

Minimum Surface Area: 40.61m²
10976mm (L) 4791mm (W)

Free Fall Height: 1500mm



Double Deck Unit 5

Product Dimensions
5124mm (L) 4183mm (W) 2945mm (H)

Minimum Surface Area: 48.66m²
8592mm (L) 7036mm (W)

Free Fall Height: 1800mm



Bespoke Towers available, enquire for more information.

Timber Towers

Alt Double Deck Unit 1

Product Dimensions
4678mm (L) 3090mm (W) 3149mm (H)

Minimum Surface Area: 34.61m²
8136mm (L) 6143mm (W)

Free Fall Height: 1200mm



Alt Double Deck Unit 2

Product Dimensions
5711mm (L) 3099mm (W) 3799mm (H)

Minimum Surface Area: 36.67m²
9173mm (L) 6082mm (W)

Free Fall Height: 1800mm

Steel feet as standard, bespoke rope colours available.

Timber Towers



Alt Double Deck Unit 3

Product Dimensions
6706mm (L) 2841mm (W) 2605mm (H)

Minimum Surface Area: 41.6m²
10175mm (L) 5813mm (W)

Free Fall Height: 1500mm

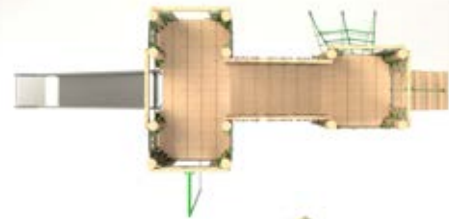

Alt Double Deck Unit 4

Product Dimensions
4233mm (L) 3880mm (W) 3699mm (H)

Minimum Surface Area: 35.57m²
7363mm (L) 7216mm (W)

Free Fall Height: 1500mm



Bespoke Towers available, enquire for more information.

Timber Towers

Triple Deck Unit 1

Product Dimensions
6638mm (L) 4081mm (W) 2310mm (H)

Minimum Surface Area: 52.58m²
10090mm (L) 7036mm (W)

Free Fall Height: 1200mm

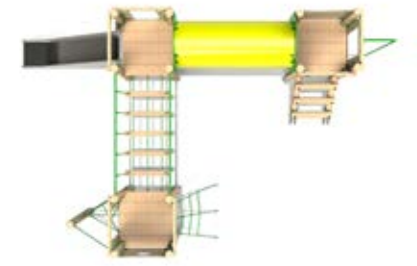
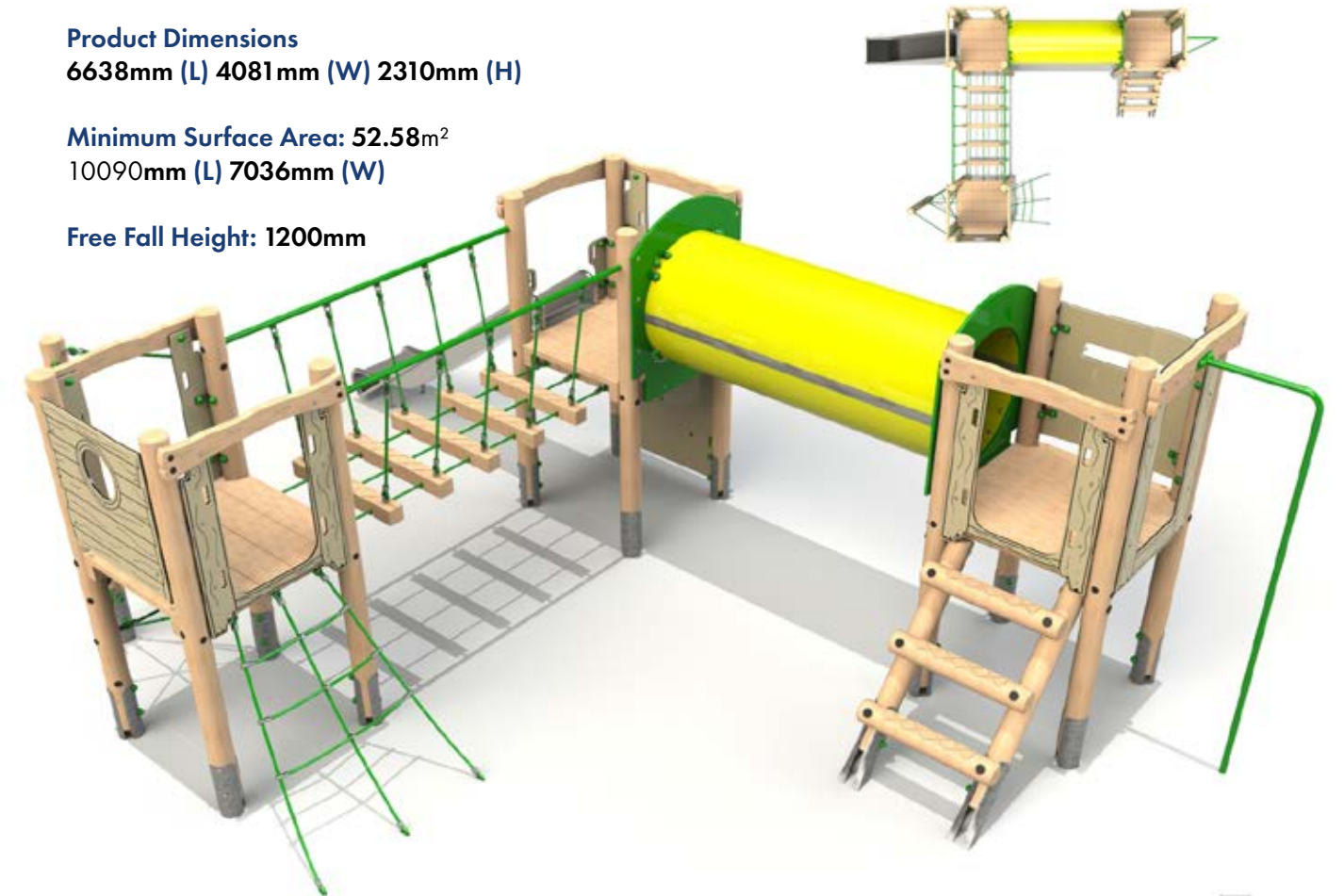

Triple Deck Unit 2

Product Dimensions
6377mm (L) 5803mm (W) 3699mm (H)

Minimum Surface Area: 53.78m²
9846mm (L) 8786mm (W)

Free Fall Height: 1500mm

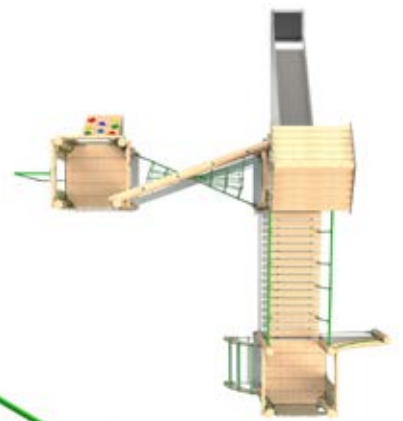

Steel feet as standard, bespoke rope colours available.

Timber Towers

Triple Deck Unit 3

Product Dimensions
7099mm (L) 4489mm (W) 3399mm (H)

Minimum Surface Area: 56.78m²
10054mm (L) 7958mm (W)

Free Fall Height: 1500mm



Triple Deck Unit 4

Product Dimensions
6982mm (L) 5059mm (W) 3449mm (H)

Minimum Surface Area: 54.83m²
10435mm (L) 7992mm (W)

Free Fall Height: 1677mm

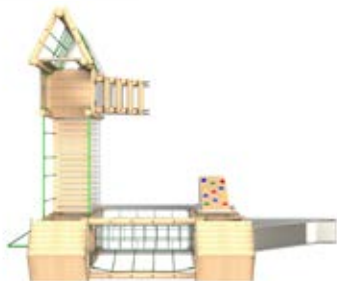

Bespoke Towers available, enquire for more information.

Timber Towers

Four Deck Unit 1

Product Dimensions
6546mm (L) 4664mm (W) 3149mm (H)

Minimum Surface Area: 58.06m²
9410mm (L) 7620mm (W)

Free Fall Height: 1200mm



Four Deck Unit 2

Product Dimensions
7508mm (L) 4630mm (W)
3501mm (H)

Minimum Surface Area: 69.74m²
10977mm (L) 7576mm (W)

Free Fall Height: 1500mm

Steel feet as standard, bespoke rope colours available.

Timber Towers

Four Deck Unit 3

Product Dimensions
8194mm (L) 5243mm (W) 3449mm (H)

Minimum Surface Area: 74.33m²
11186mm (L) 8196mm (W)

Free Fall Height: 1500mm



Four Deck Unit 4

Product Dimensions
10371mm (L) 4131mm (W) 2970mm (H)

Minimum Surface Area: 62.32m²
13360mm (L) 7600mm (W)

Free Fall Height: 1500mm



Bespoke Towers available, enquire for more information.

Timber Towers

Alt Four Deck Unit 1

Product Dimensions
6313mm (L) 6107mm (W) 3799mm (H)

Minimum Surface Area: 63.92m²
9289mm (L) 9099mm (W)

Free Fall Height: 1895mm



Alt Four Deck Unit 2

Product Dimensions
9403mm (L) 8049mm (W) 2905mm (H)

Minimum Surface Area: 79.2m²
13332mm (L) 11038mm (W)

Free Fall Height: 1800mm

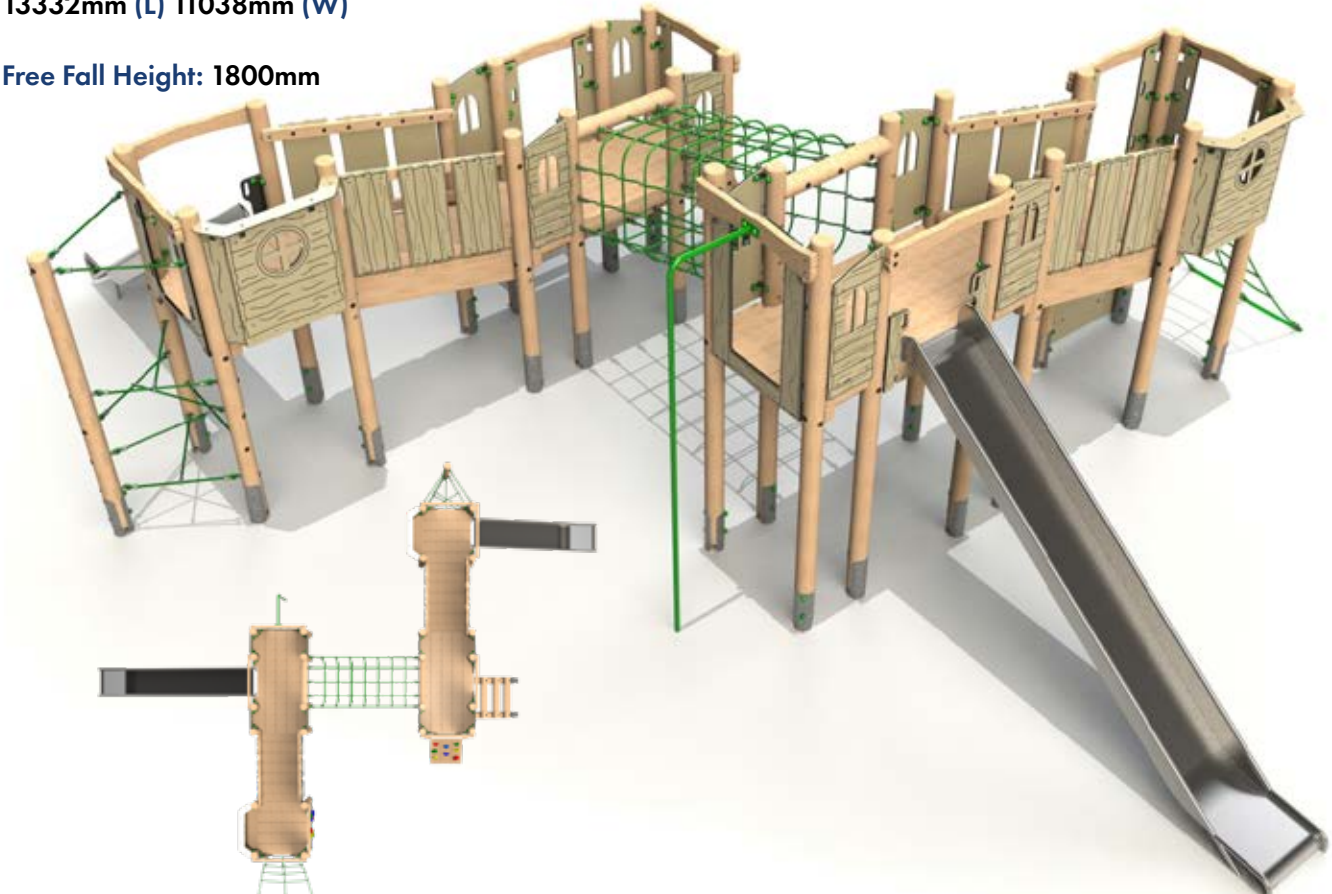

Steel feet as standard, bespoke rope colours available.

Timber Towers

Alt Four Deck Unit 3

Product Dimensions
7787mm (L) 5579mm (W) 2745mm (H)

Minimum Surface Area: 68.53m²
11249mm (L) 8718mm (W)

Free Fall Height: 1800mm

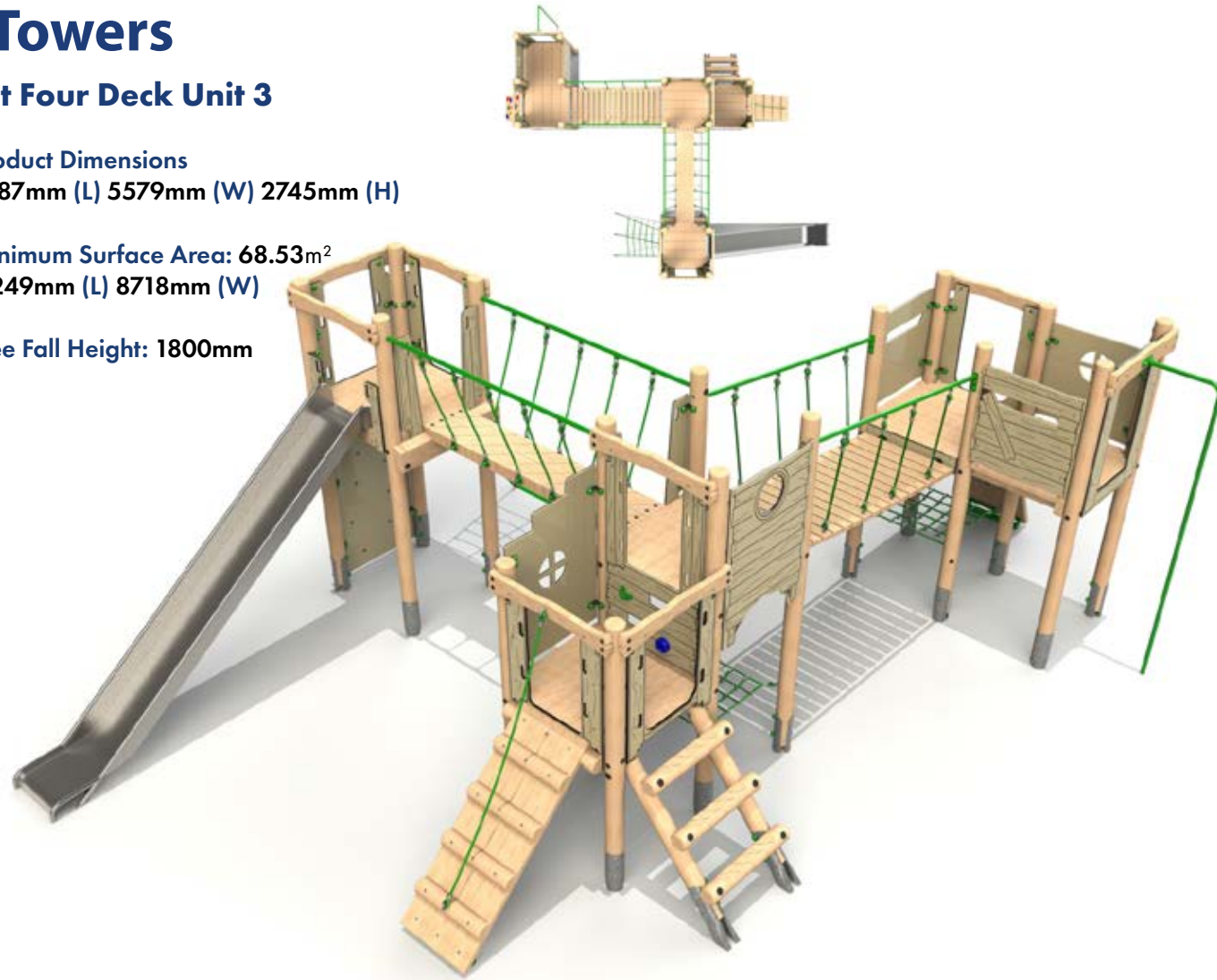

Castle Tower 1

Product Dimensions
3965mm (L) 2524mm (W) 3425mm (H)

Minimum Surface Area: 28.96m²
7408mm (L) 5449mm (W)

Free Fall Height: 1500mm

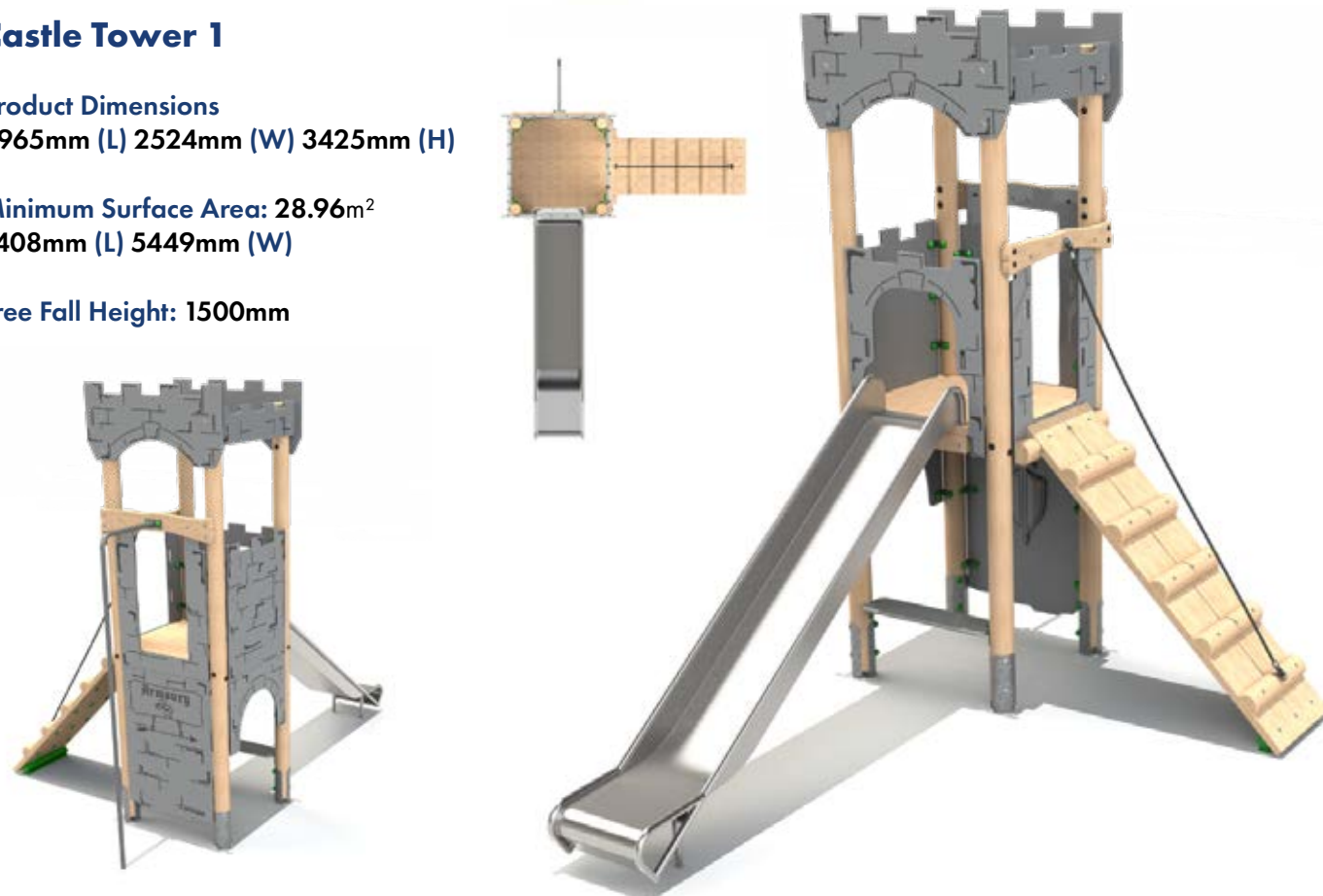

Bespoke Towers available, enquire for more information.

Timber Towers

Castle Tower 2

Product Dimensions
4696mm (L) 2505mm (W) 3191mm (H)

Minimum Surface Area: 40.33m²
7614mm (L) 7554mm (W)

Free Fall Height: 1327mm

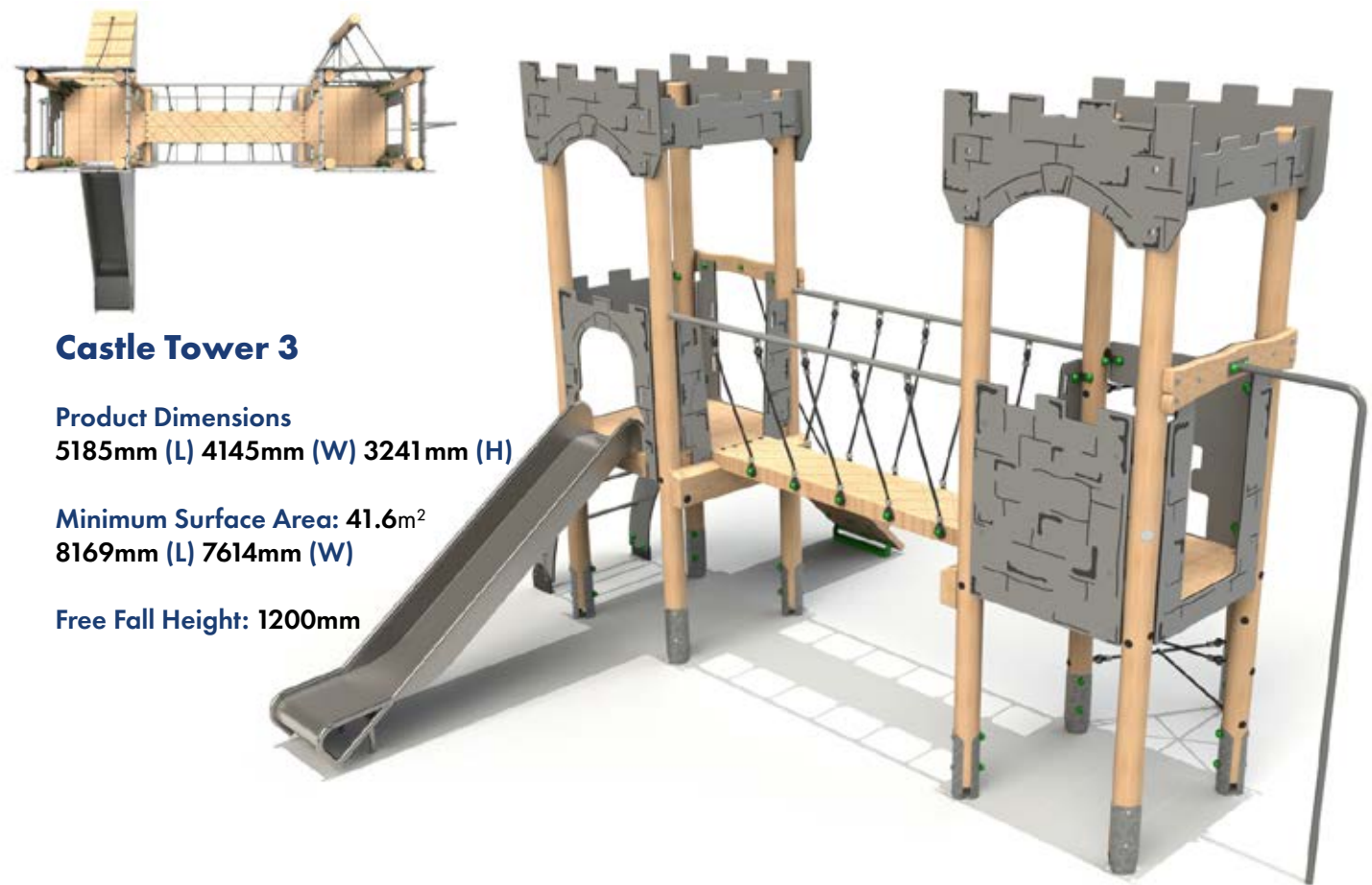

Castle Tower 3

Product Dimensions
5185mm (L) 4145mm (W) 3241mm (H)

Minimum Surface Area: 41.6m²
8169mm (L) 7614mm (W)

Free Fall Height: 1200mm

Steel feet as standard, bespoke rope colours available.

Timber Towers

Castle Tower 4

Product Dimensions
4717mm (L) 3903mm (W) 3490mm (H)

Minimum Surface Area: 41.31m²
7625mm (L) 7371mm (W)

Free Fall Height: 1500mm



Castle Tower 5

Product Dimensions
5684mm (L) 3965mm (W) 3460mm (H)

Minimum Surface Area: 42.57m²
8693mm (L) 7417mm (W)

Free Fall Height: 1500mm

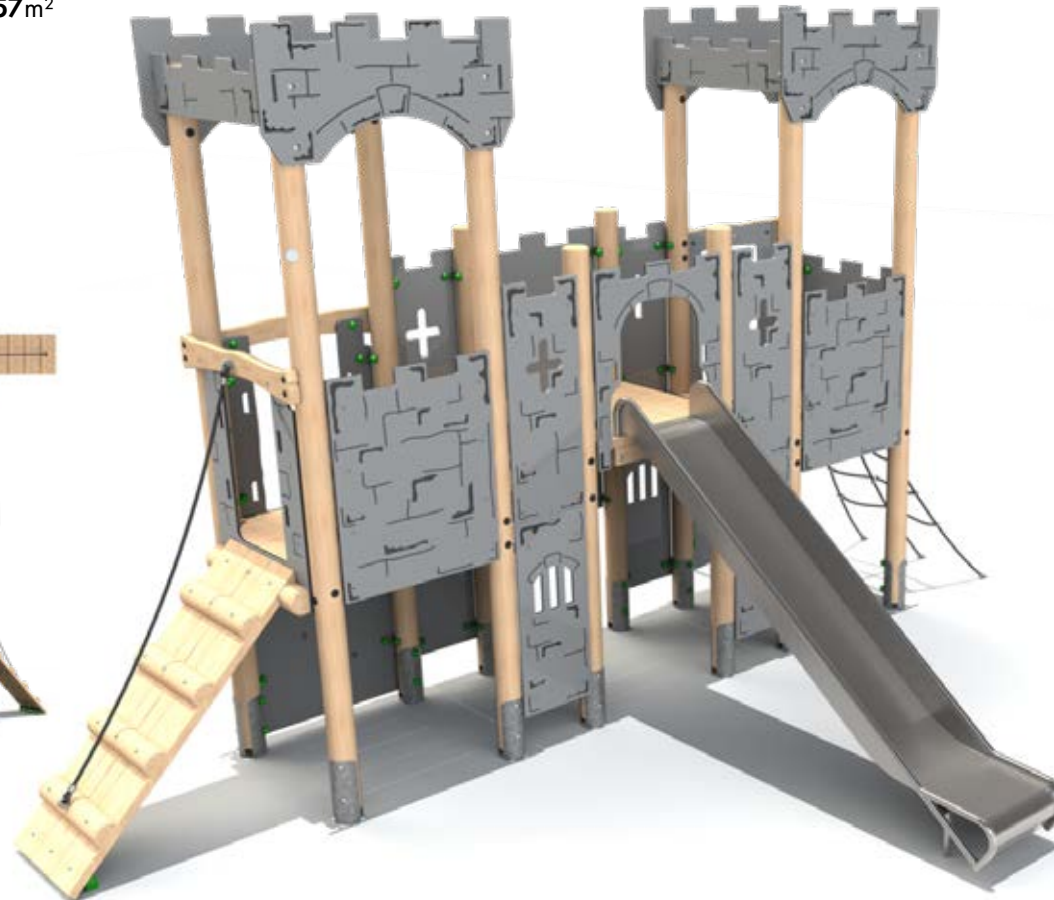
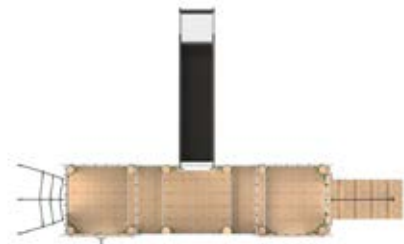

Timber Towers



Castle Tower 6

Product Dimensions
5242mm (L) 4603mm (W)
3491mm (H)

Minimum Surface Area: 51.32m²
8167mm (L) 7611mm (W)

Free Fall Height: 1500mm

Castle Tower 7

Product Dimensions
9085mm (L) 6029mm (W)
3841mm (H)

Minimum Surface Area: 65.73m²
12531mm (L) 9029mm (W)

Free Fall Height: 1927mm

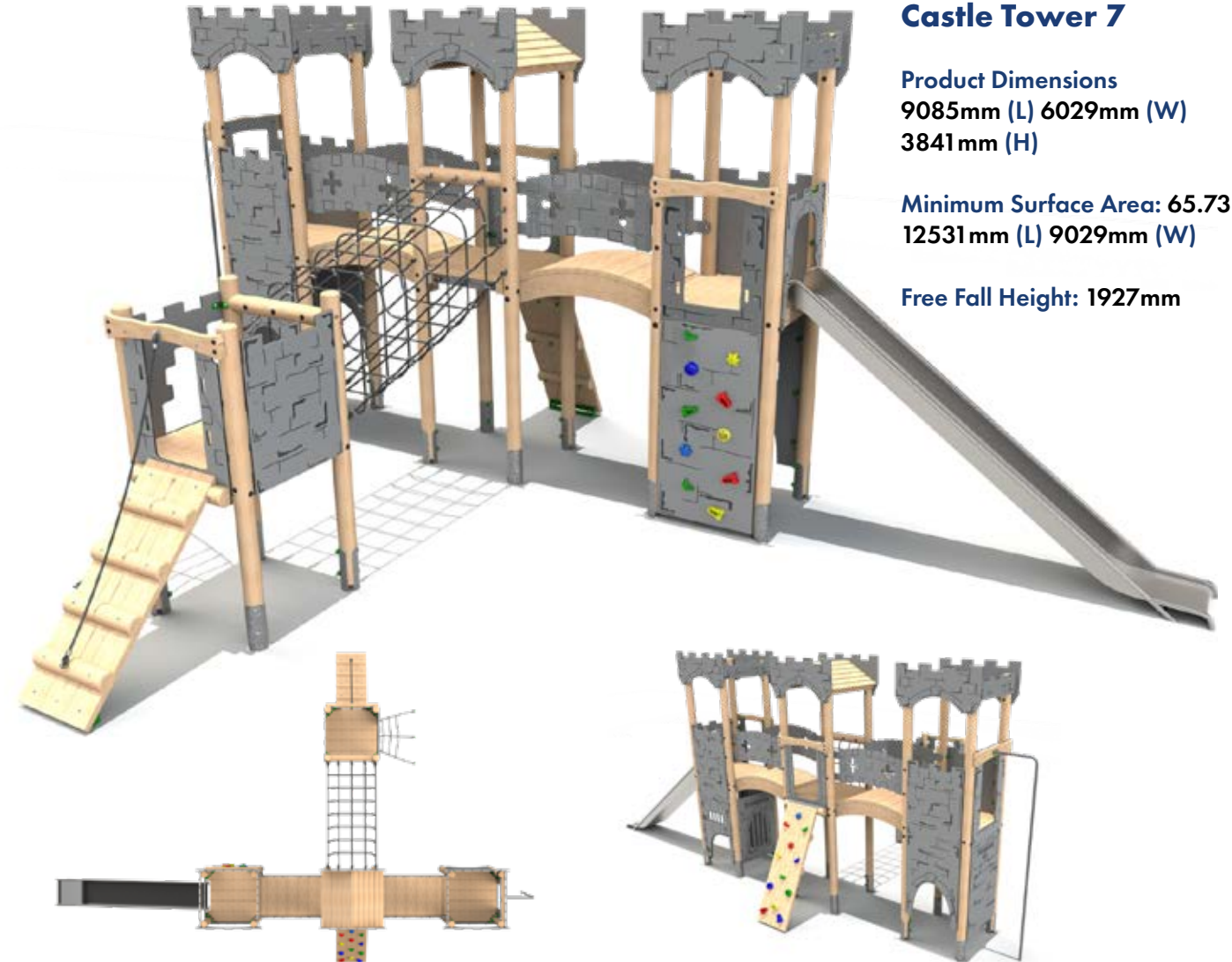

Bespoke Towers available, enquire for more information.

Steel feet as standard, bespoke rope colours available.

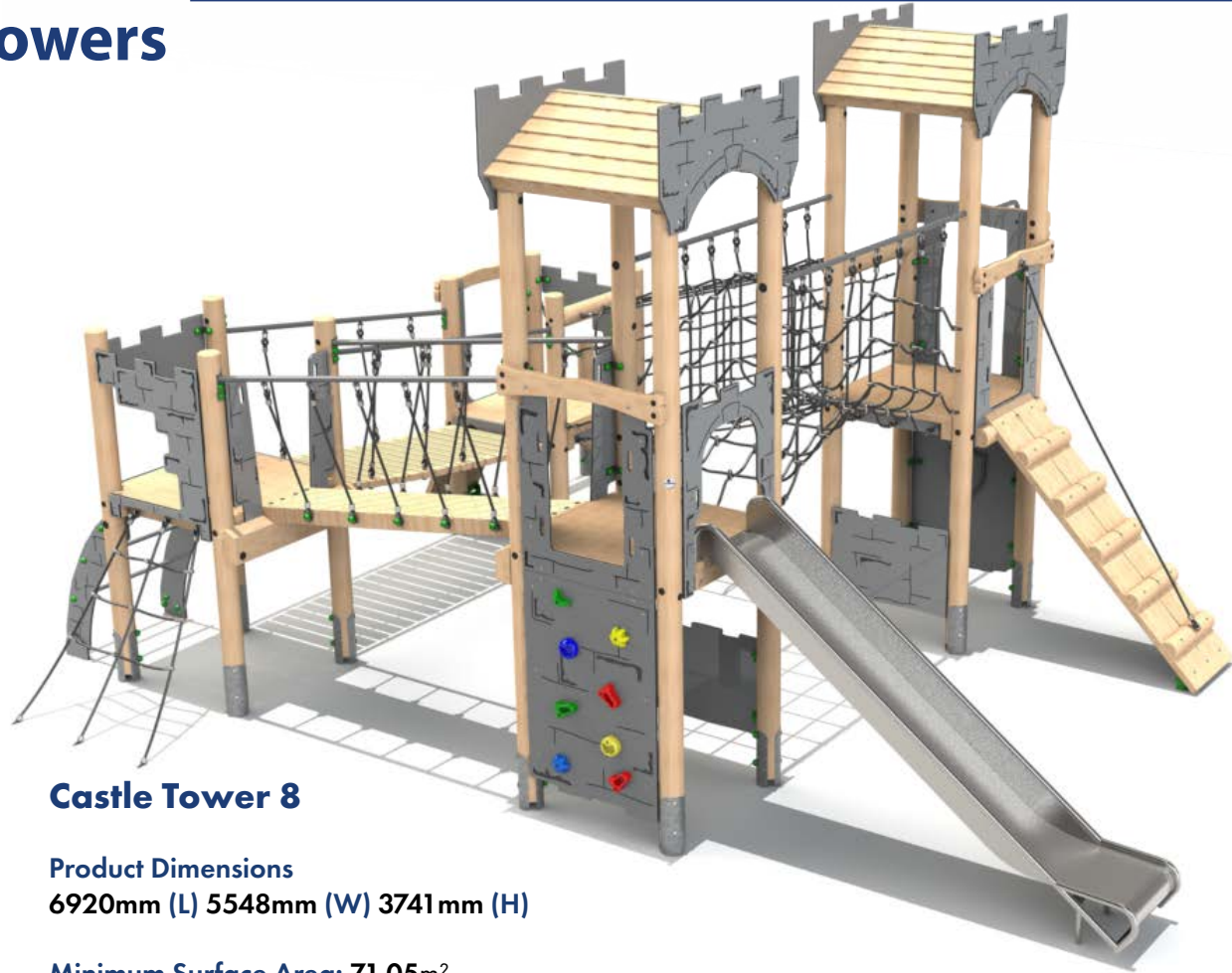

Castle Tower 8

Product Dimensions
6920mm (L) 5548mm (W) 3741mm (H)

Minimum Surface Area: 71.05m²
10390mm (L) 8556mm (W)

Free Fall Height: 1500mm

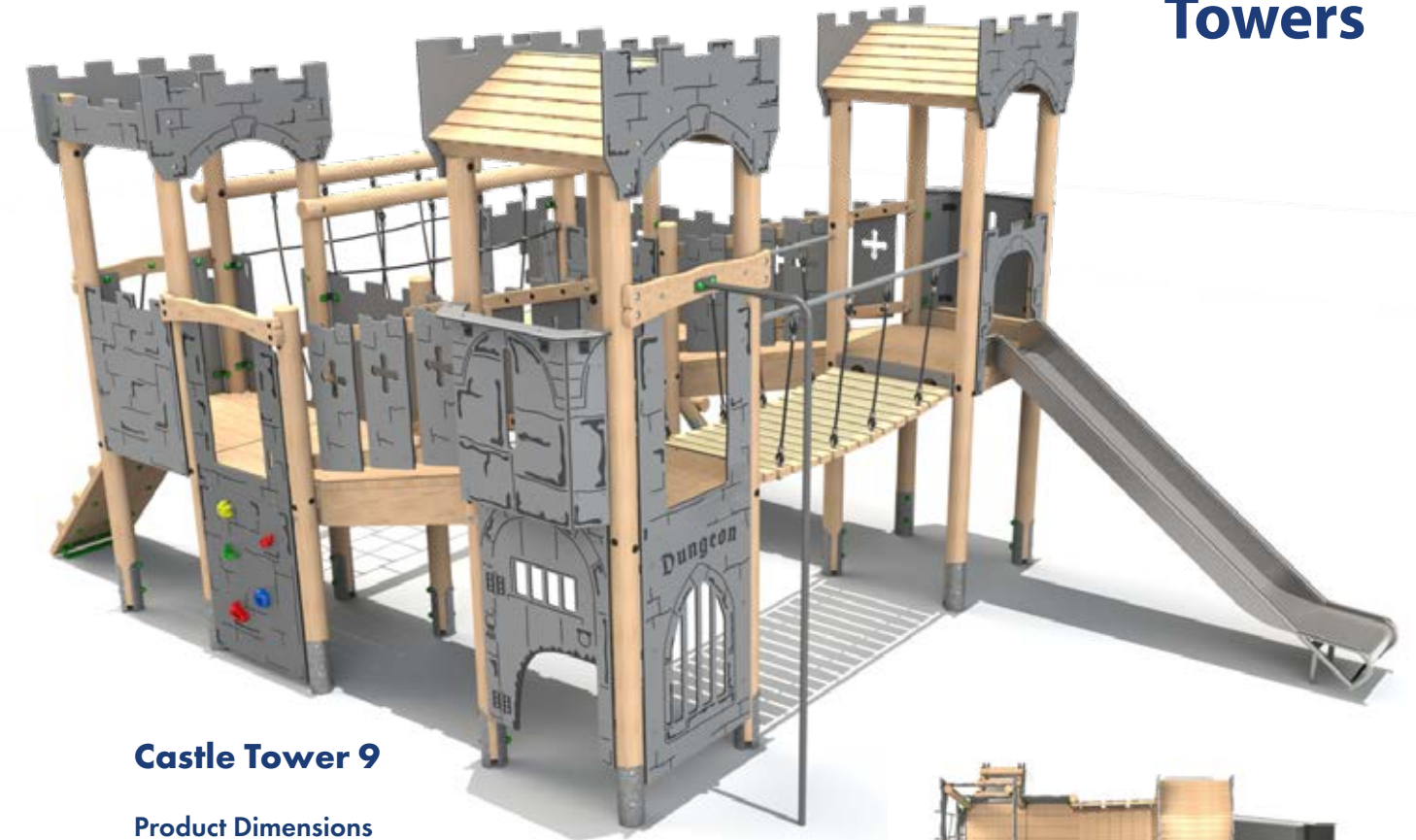
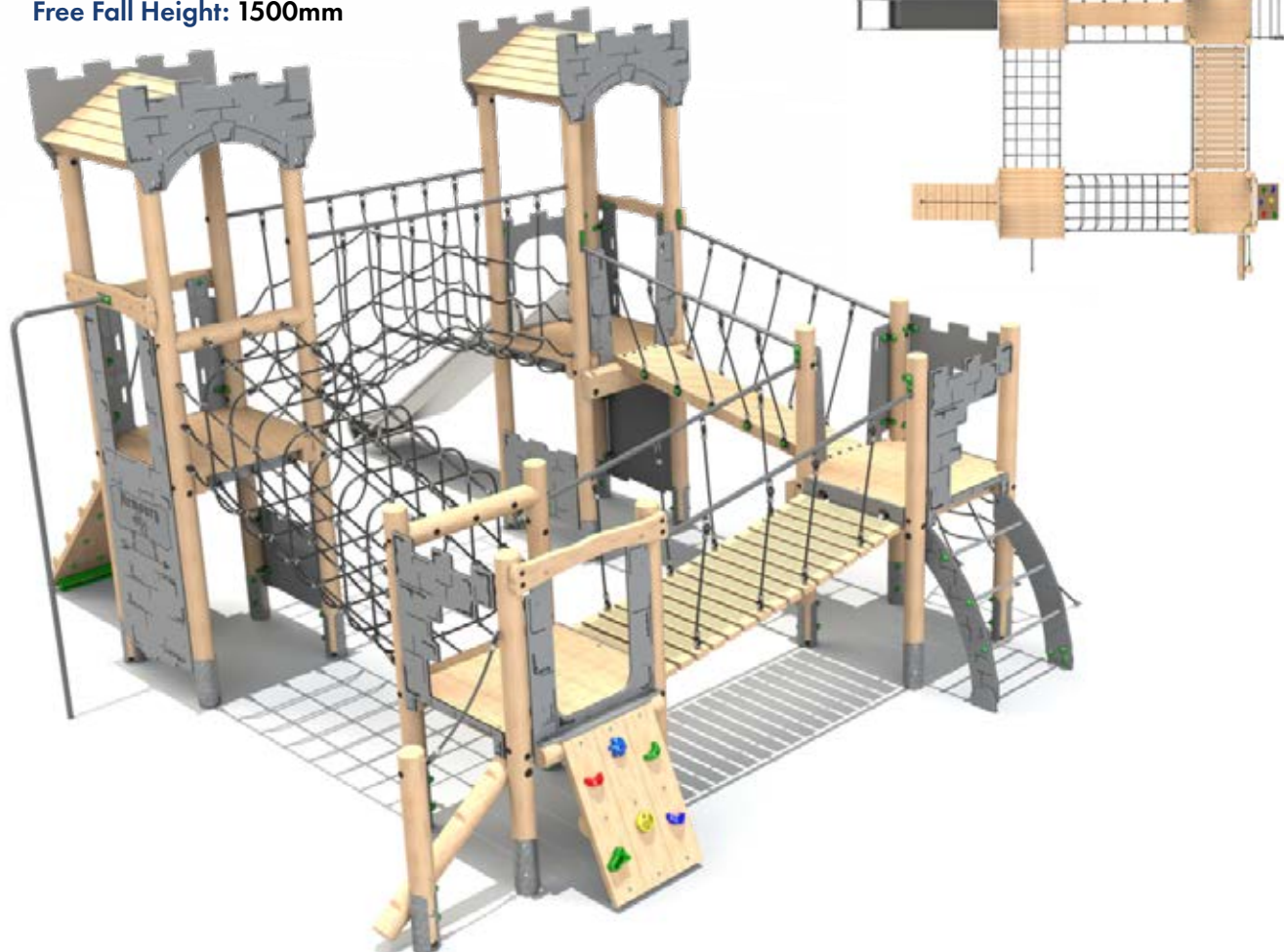

Castle Tower 9

Product Dimensions
7599mm (L) 5119mm (W) 3491mm (H)

Minimum Surface Area: 65.84m²
10697mm (L) 8134mm (W)

Free Fall Height: 1500mm

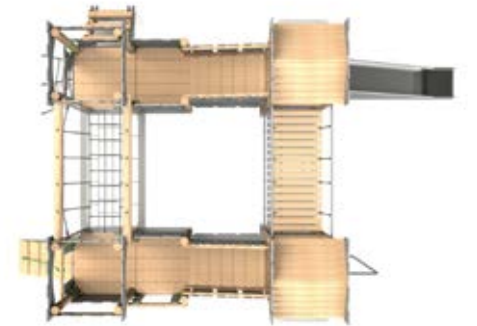

Timber Towers

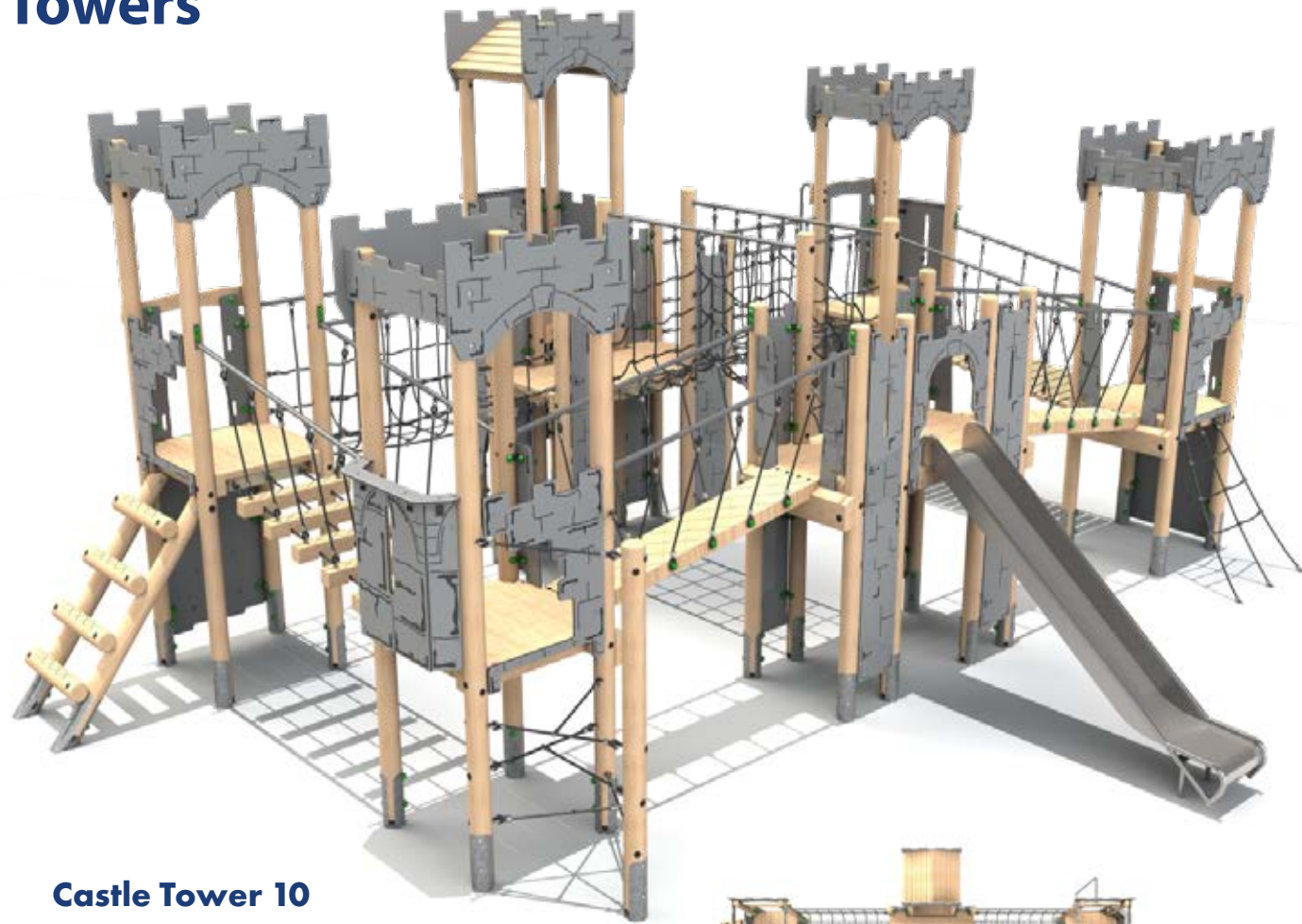

Castle Tower 10

Product Dimensions
9243mm (L) 7490mm (W) 4041mm (H)

Minimum Surface Area: 97.08m²
12251mm (L) 10929mm (W)

Free Fall Height: 1895mm

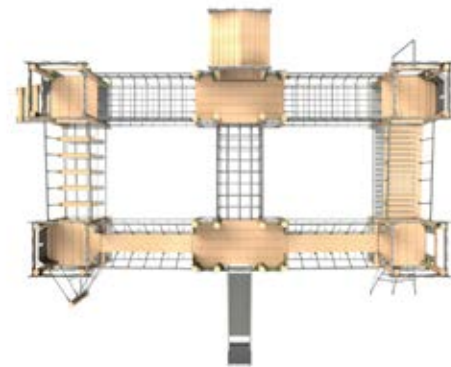

Bespoke Towers available, enquire for more information.

Timber Towers

Clamber Tower 2

Product Dimensions
6091mm (L) 4842mm (W) 2678mm (H)

Minimum Surface Area: 54.32m²
9257mm (L) 8535mm (W)

Free Fall Height: 1500mm

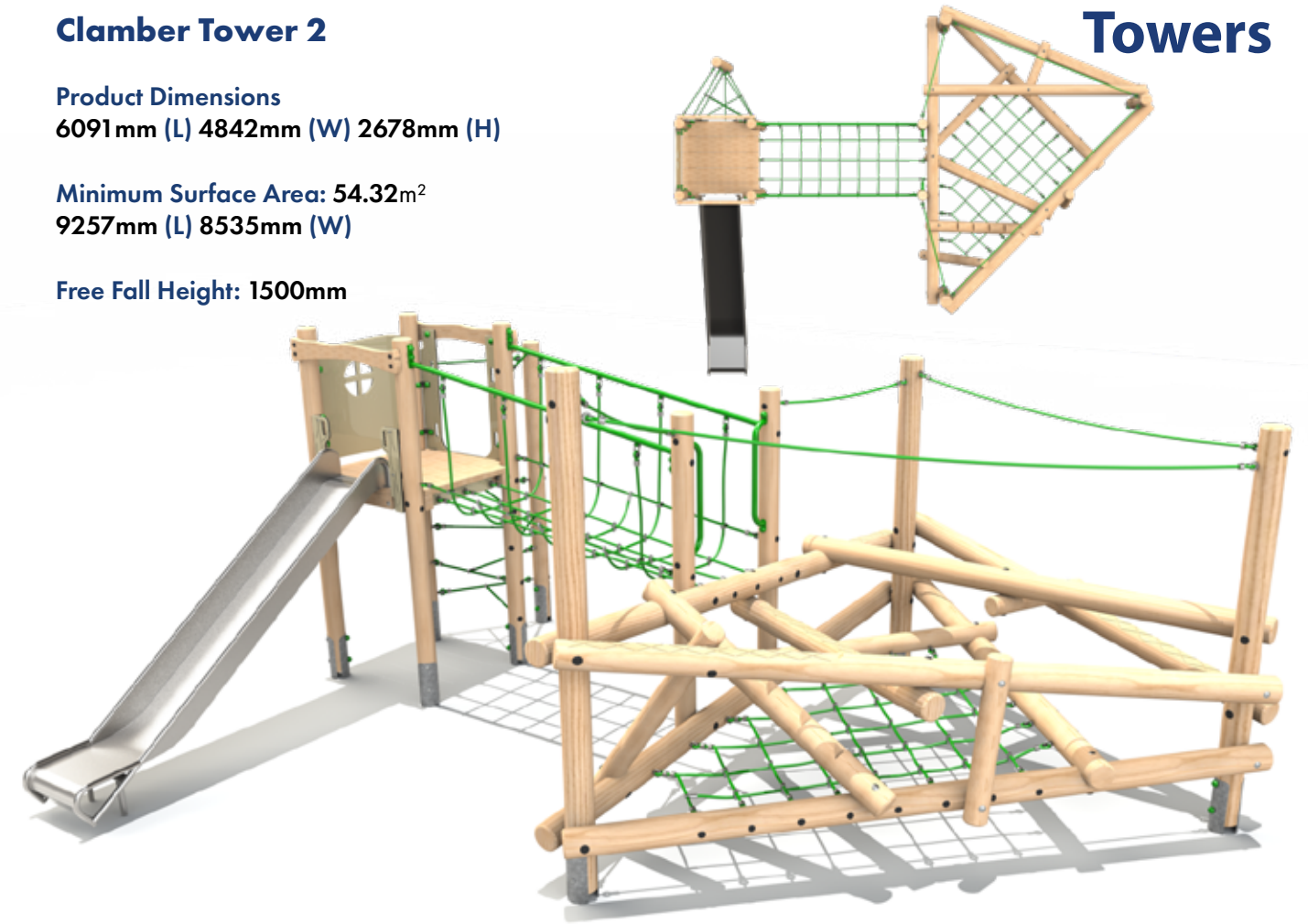

Clamber Tower 2 Castle

Product Dimensions
6636mm (L) 4842mm (W)
3535mm (H)

Minimum Surface Area: 54.54m²
9802mm (L) 8535mm (W)

Free Fall Height: 1500mm

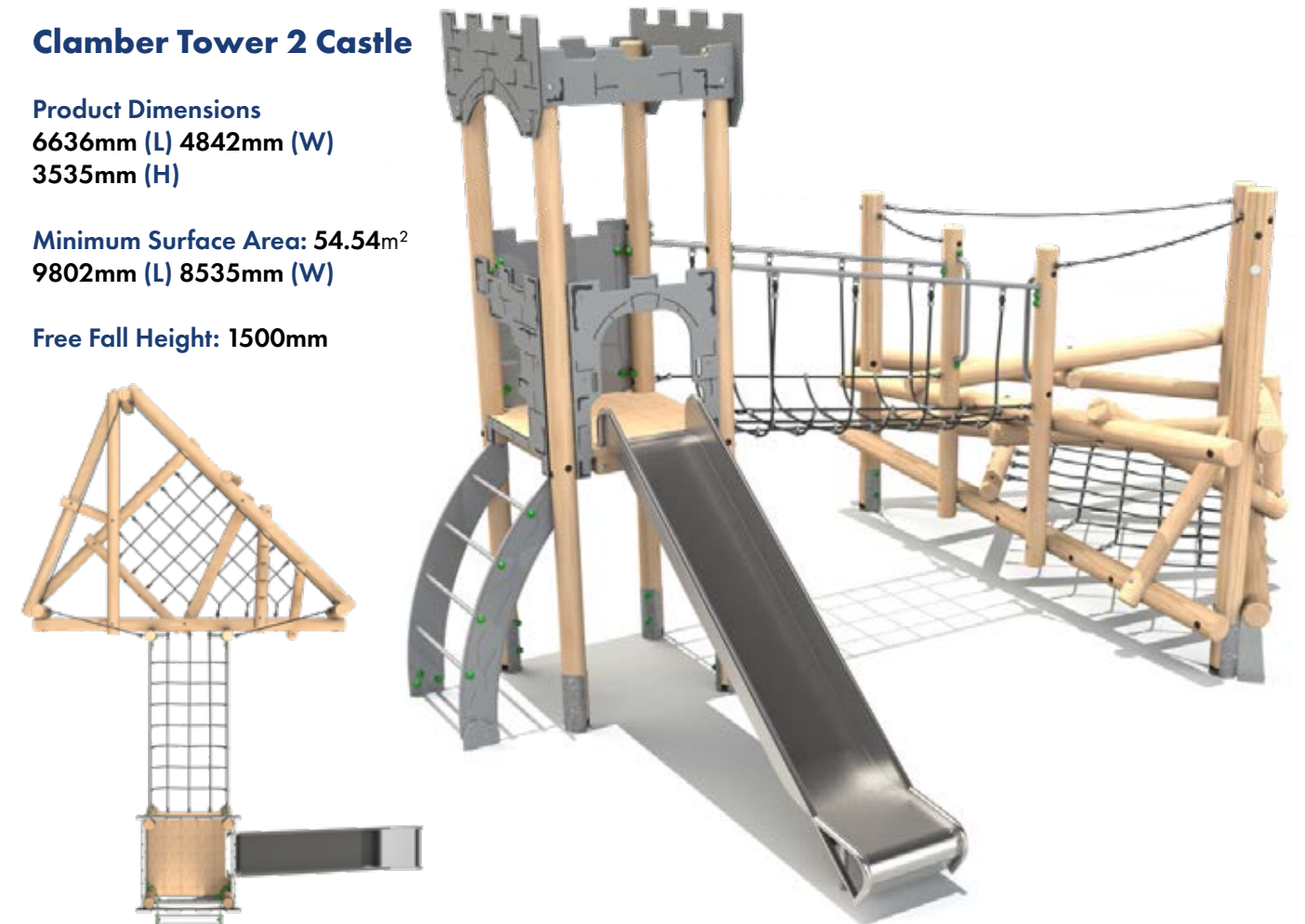

Steel feet as standard, bespoke rope colours available.

Timber Towers

Clamber Tower Mezzo

Product Dimensions
6372mm (L) 5978mm (W) 2854mm (H)

Minimum Surface Area: 63.91m²
9366mm (L) 9477mm (W)

Free Fall Height: 1500mm

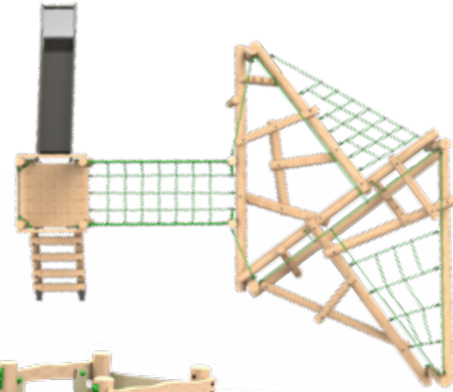
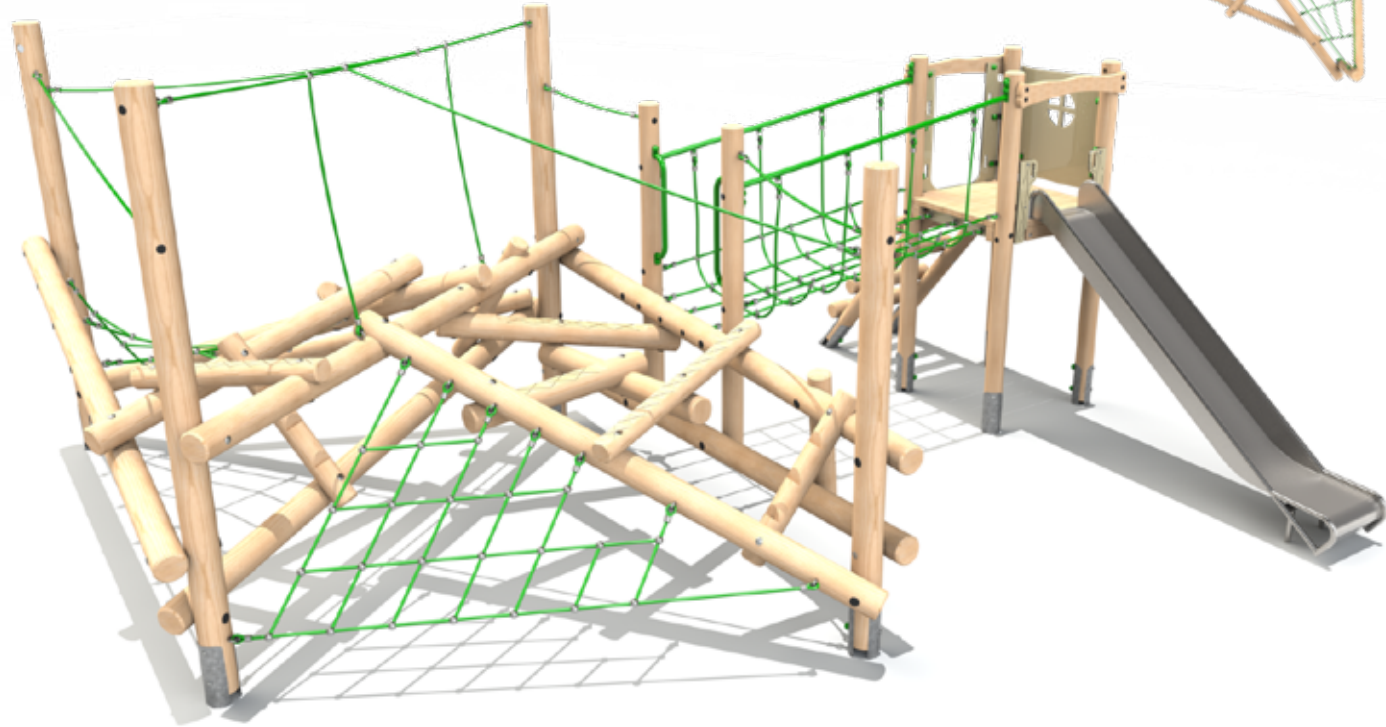

Clamber Tower 3 Double Deck Castle

Product Dimensions
9484mm (L) 5543mm (W)
3740mm (H)

Minimum Surface Area: 78.91m²
13081mm (L) 8467mm (W)

Free Fall Height: 1500mm

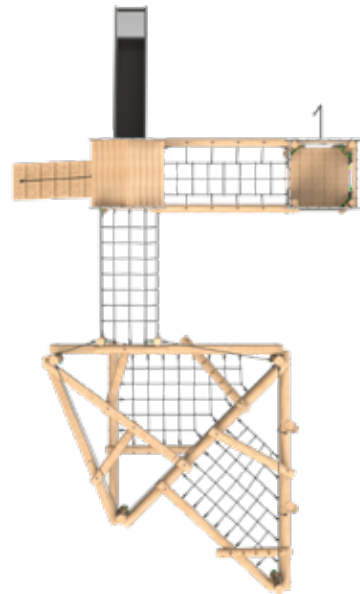
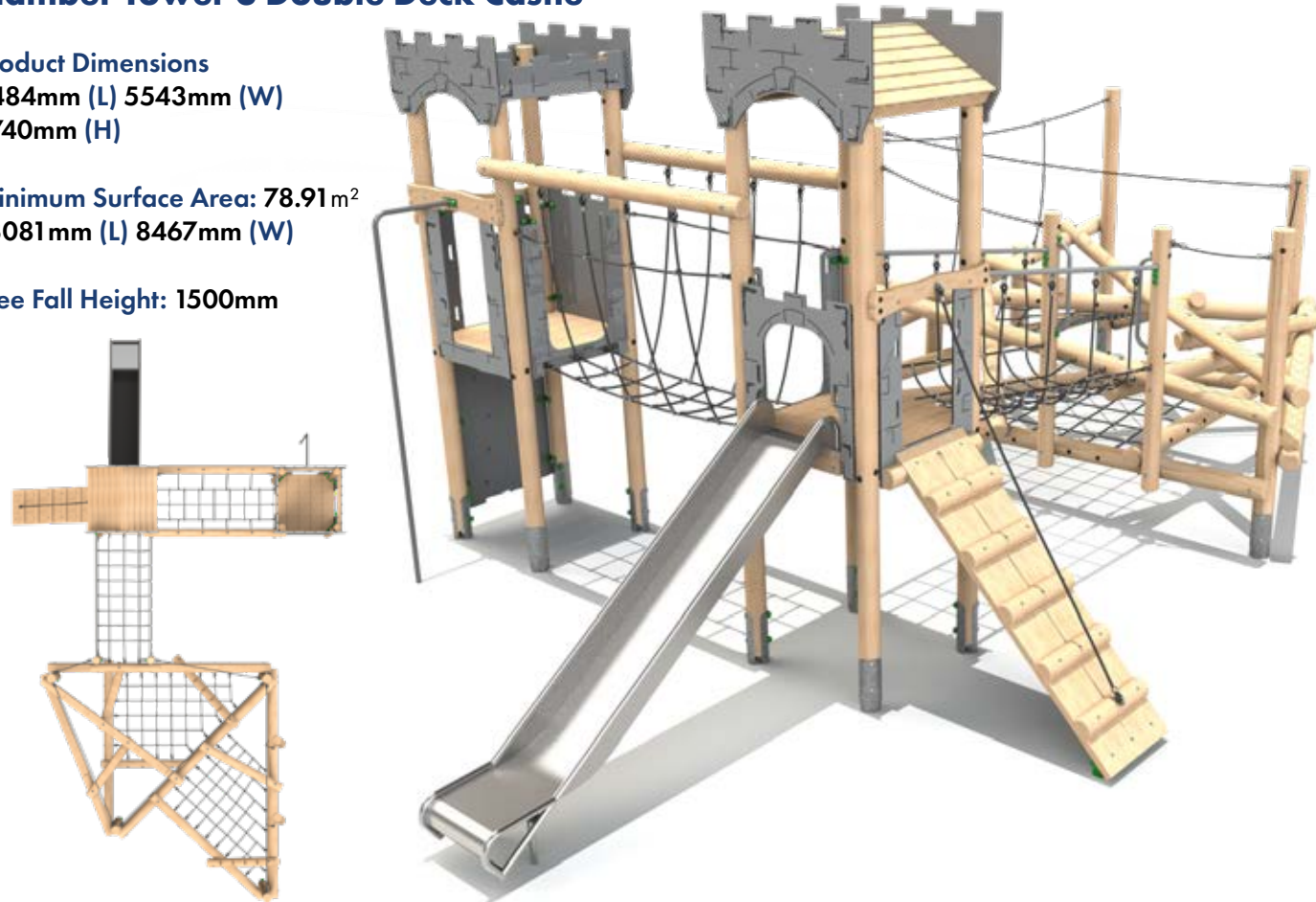

Bespoke Towers available, enquire for more information.

Timber Towers

Clamber Tower 3

Product Dimensions
7141mm (L) 4278mm (W) 2700mm (H)

Minimum Surface Area: 63.18m²
10272mm (L) 7990mm (W)

Free Fall Height: 1500mm

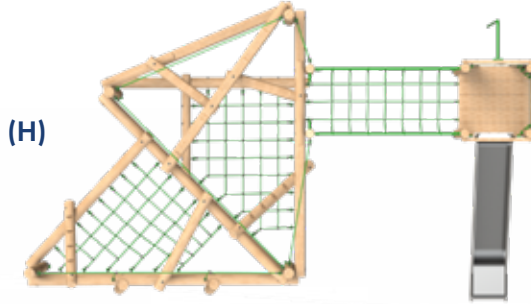
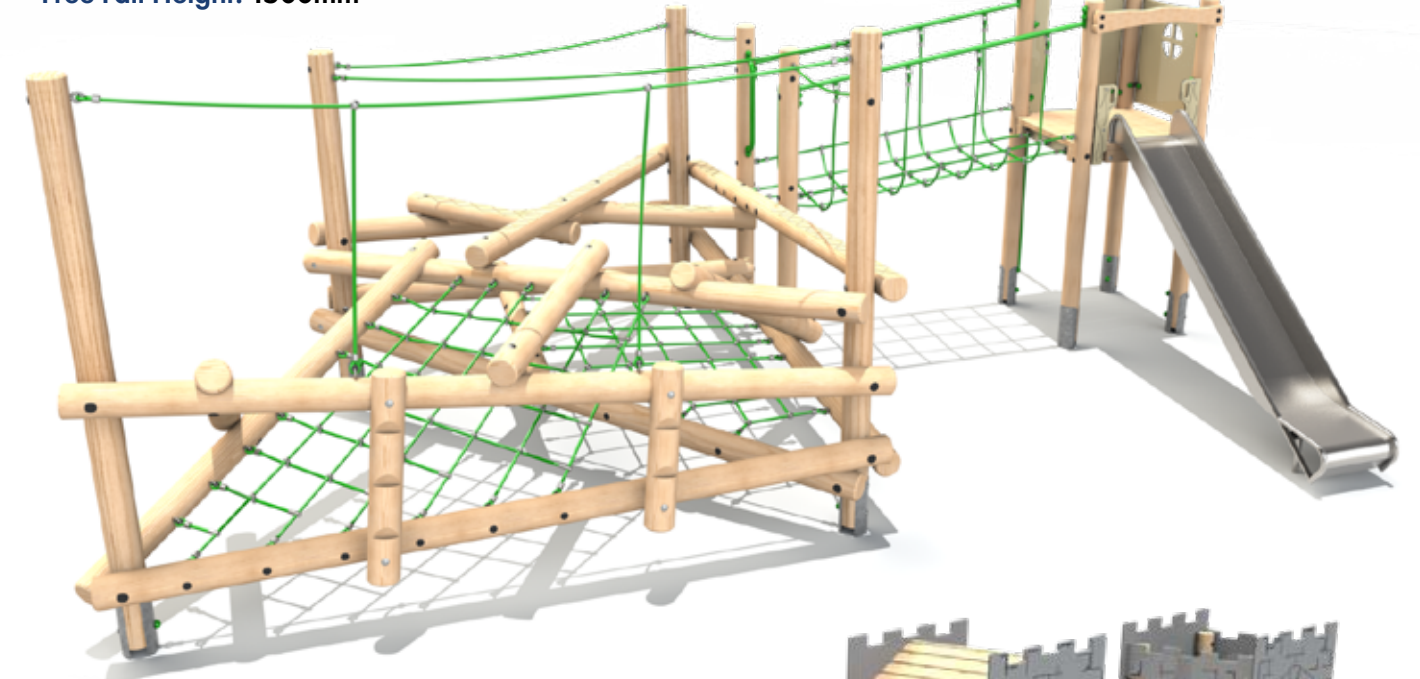

Clamber Tower 3 Triple Deck Castle

Product Dimensions
9484mm (L) 8203mm (W) 3737mm (H)

Minimum Surface Area: 91.54m²
13081mm (L) 11129mm (W)

Free Fall Height: 1500mm

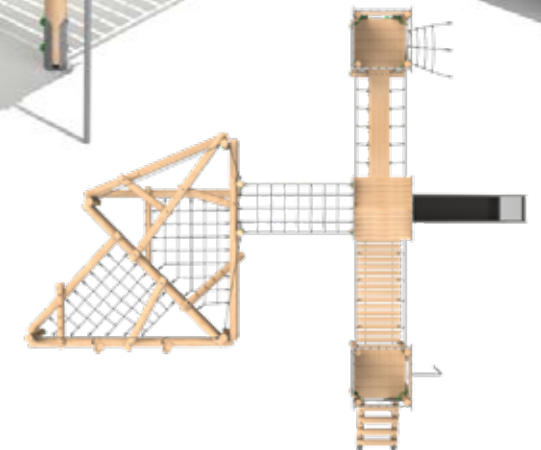

Steel feet as standard, bespoke rope colours available.



Castle Slide Unit

Product Dimensions
3830mm (L) 1090mm (W) 2270mm (H)

Minimum Surface Area: 24.5m²
7160mm (L) 3990mm (W)

Free Fall Height: 900mm

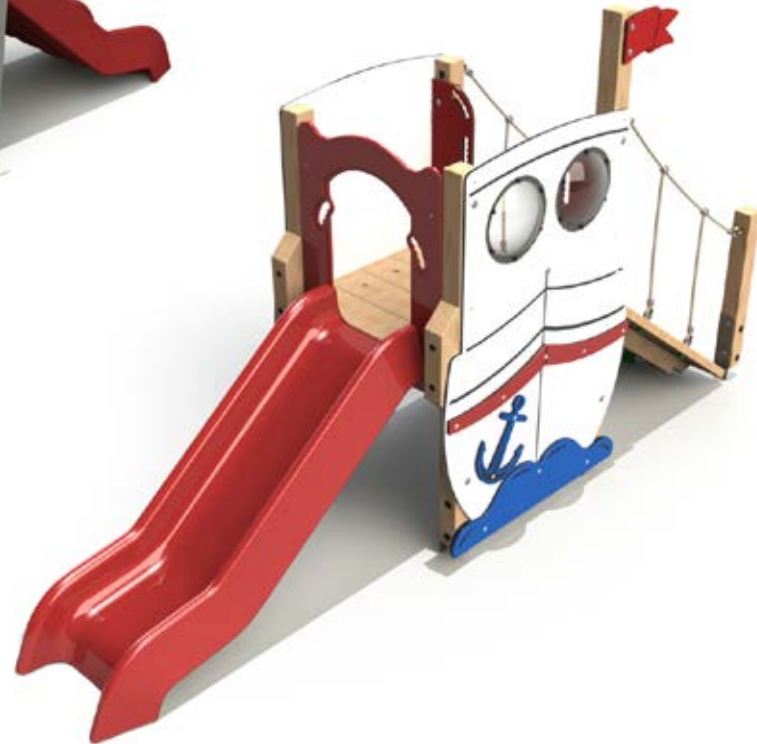

Boat Slide Unit

Product Dimensions
3830mm (L) 1120mm (W) 2170mm (H)

Minimum Surface Area: 24.5m²
7160mm (L) 3990mm (W)

Free Fall Height: 900mm



Dump Truck Slide Unit

Product Dimensions
4040mm (L) 1060mm (W) 1810mm (H)

Minimum Surface Area: 24.5m²
7160mm (L) 3990mm (W)

Free Fall Height: 900mm

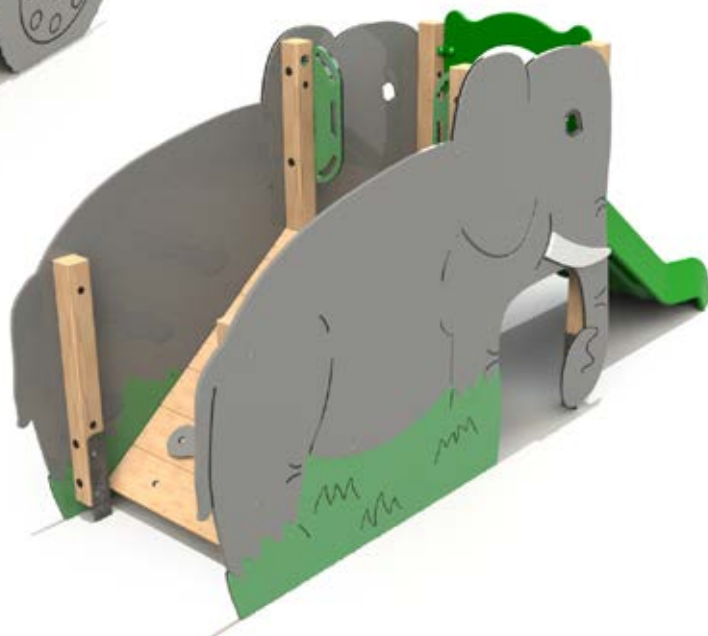

Elephant Slide Unit

Product Dimensions
4040mm (L) 1070mm (W)
1730mm (H)

Minimum Surface Area: 24.5m²
7160mm (L) 3990mm (W)

Free Fall Height: 900mm



Fire Engine Slide Unit

Product Dimensions
3880mm (L) 1070mm (W) 1810mm (H)

Minimum Surface Area: 24.5m²
7160mm (L) 3990mm (W)

Free Fall Height: 900mm

Rocket Slide Unit

Product Dimensions
3840mm (L) 1180mm (W) 2460mm (H)

Minimum Surface Area: 24.5m²
7160mm (L) 3990mm (W)

Free Fall Height: 900mm

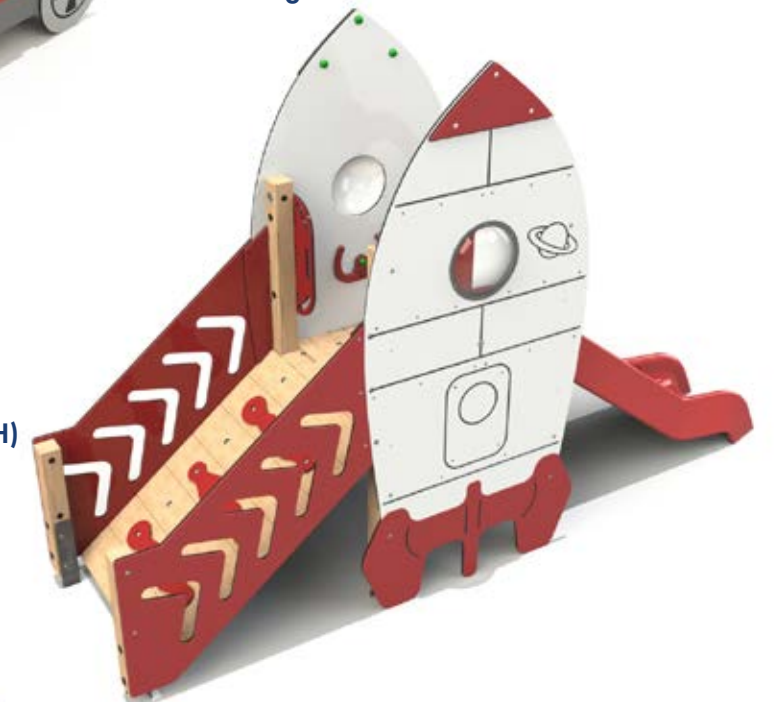

Submarine Slide Unit

Product Dimensions
4040mm (L) 1170mm (W) 2310mm (H)

Minimum Surface Area: 24.5m²
7160mm (L) 3990mm (W)

Free Fall Height: 900mm



Whale Slide Unit

Product Dimensions
3970mm (L) 1180mm (W) 2270mm (H)

Minimum Surface Area: 24.5m²
7160mm (L) 3990mm (W)

Free Fall Height: 900mm

